

ASHURST HOSPITAL

A HEALTH AND WELLBEING CENTRE FOR CHILDREN,
YOUNG PEOPLE AND FAMILIES



The vision and key drivers for change

The vision is to provide a health and wellbeing centre at Ashurst Hospital which brings together a wide range of services for children, young people and families living across the West New Forest and Totton and Waterside Localities and Romsey.

The scheme at Ashurst will enable:

- High quality clinical healthcare to be delivered close to home from facilities which are friendly and welcoming and which will meet the needs of younger people across the New Forest.
- Co-location of physical and mental health and support services will enhance the ability to provide holistic child centred care which is wrapped around the needs of the child.
- Better access to care
- The redevelopment of poor quality and underutilised accommodation on the Ashurst Hospital campus.

What have we heard? Early engagement - The Vision

Engagement with the local families (including young people and children), key stakeholders and health service providers has been key to the progression of the proposed scheme. The initial survey in Summer 2017 invited local families to tell us about experiences of visiting health services for children at Ashurst and other local venues and for ideas on services they would like to see brought together on the site. 323 surveys were completed.



Feedback confirmed the Birth Centre was popular and well liked. Families felt Ashurst was easy to access, close to home, convenient and less stressful than visiting other larger hospital. Families and children didn't like the old "gloomy" buildings or the lack of facilities.

The vision was well received and strongly supported. Parents and carers told to us they want their children to receive the right care as close to home as possible in buildings which are welcoming and friendly and have the right facilities to meet their needs.

The Clinical Service Model

The Clinical Services Model was developed following engagement with local paediatric health service providers and voluntary sector organisations and based on health and wellbeing services local families told us they would like to see provided at Ashurst.



Proposed Site Master Plan

The proposed development at Ashurst Hospital is included in the New Forest National Park Local Plan 2016 – 2036 under Policy SP23. NHS Property Services have developed a proposed Site Master Plan.

- The area to the west of the campus will be retained for future health service delivery with associated car parking.
- External space around the centre will deliver child friendly and accessible sensory gardens and play spaces
- Subject to Planning Permission, land to the east of the site will be utilised for a Care Home development
- The campus is ecologically sensitive and the protected area will remain undeveloped.



What have we heard? – What should the health centre look like?

During September and October 2020, local families, young people and children were invited to tell West Hampshire CCG and NHS Property Services, in their own words, what was important to them when they attend an appointment and what they want to see inside and outside at Ashurst Hospital.

72 adults and young people completed the main survey and 11 children under 21 completed a simplified version.

The message was simple – everything about the design of the building, both inside and outside, should be child focused and child friendly.

- Bright and colourful but still, calming and relaxing.
- Age appropriate for children and young people with a variety of things to do.
- Fully accessible in all areas (including a Changing Places toilet facility)
- External play areas and landscaping are as important as the spaces inside

Proposed designs for the Health and Wellbeing Centre

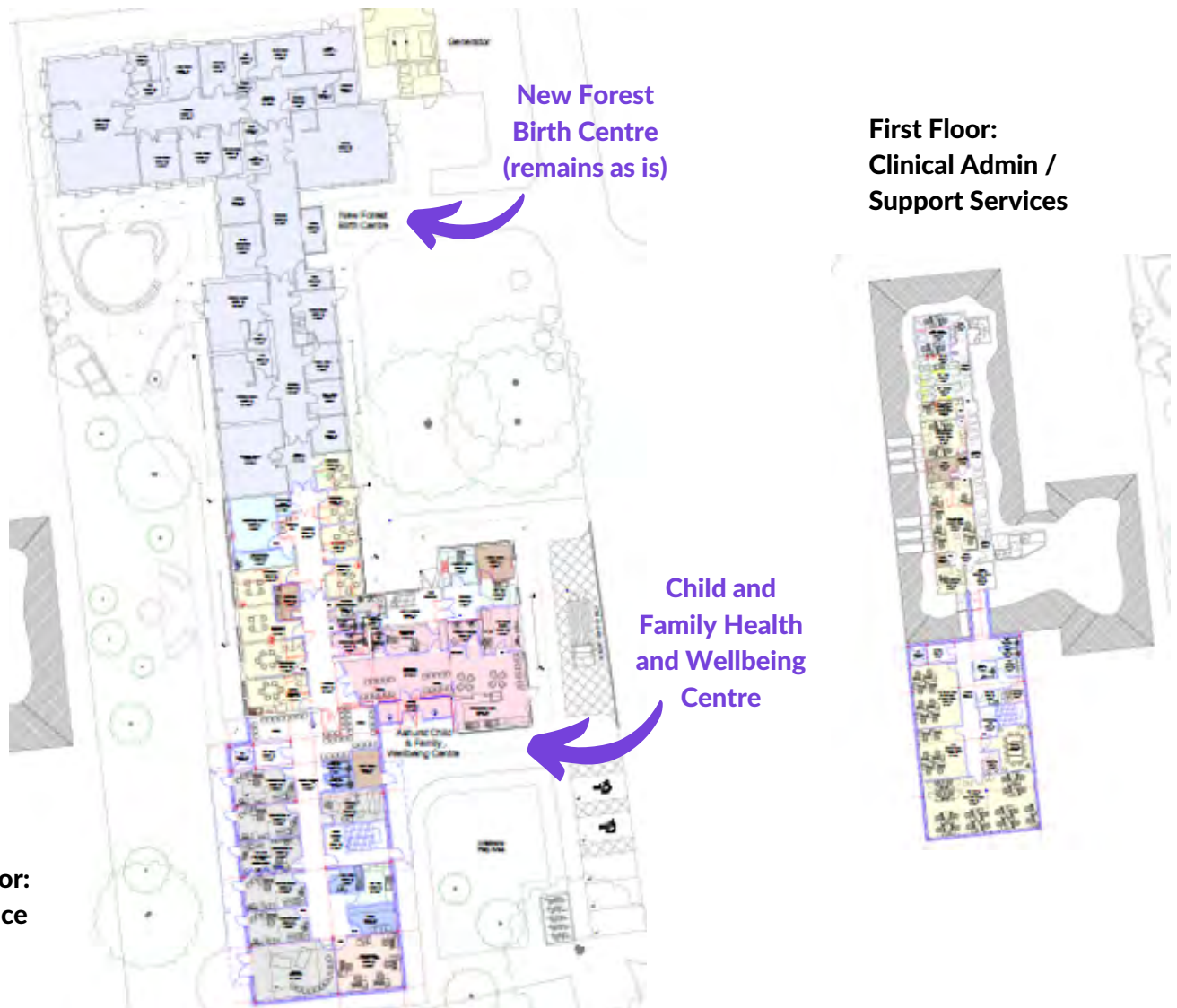

Proposed external building elevations



Proposed East Elevation (East)



Proposed South Elevation (South)

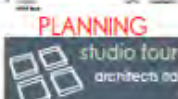

Next steps and provisional timescales

- Engagement and Listening – Landscaping design and sensory play area planning with children and families.
- Submission of Hybrid Planning Application
- Approval of Planning Application (allowing minimum 3 months)
- Full Business Case Submission
- Construction commences on site (subject to planning and business case approval)
- Operational completion and handover (target date)

May - June 2021

August 2021

November 2021

December 2021

March 2022

March 2023



Stay in touch



Website:

www.hampshiresouthamptonandisleofwightccg.nhs.uk



Twitter:

@HIOW_ICS



Facebook:

@HIOWICS



Instagram:

@HIOW_ICS